

TILE DRAIN SPECIFICATION

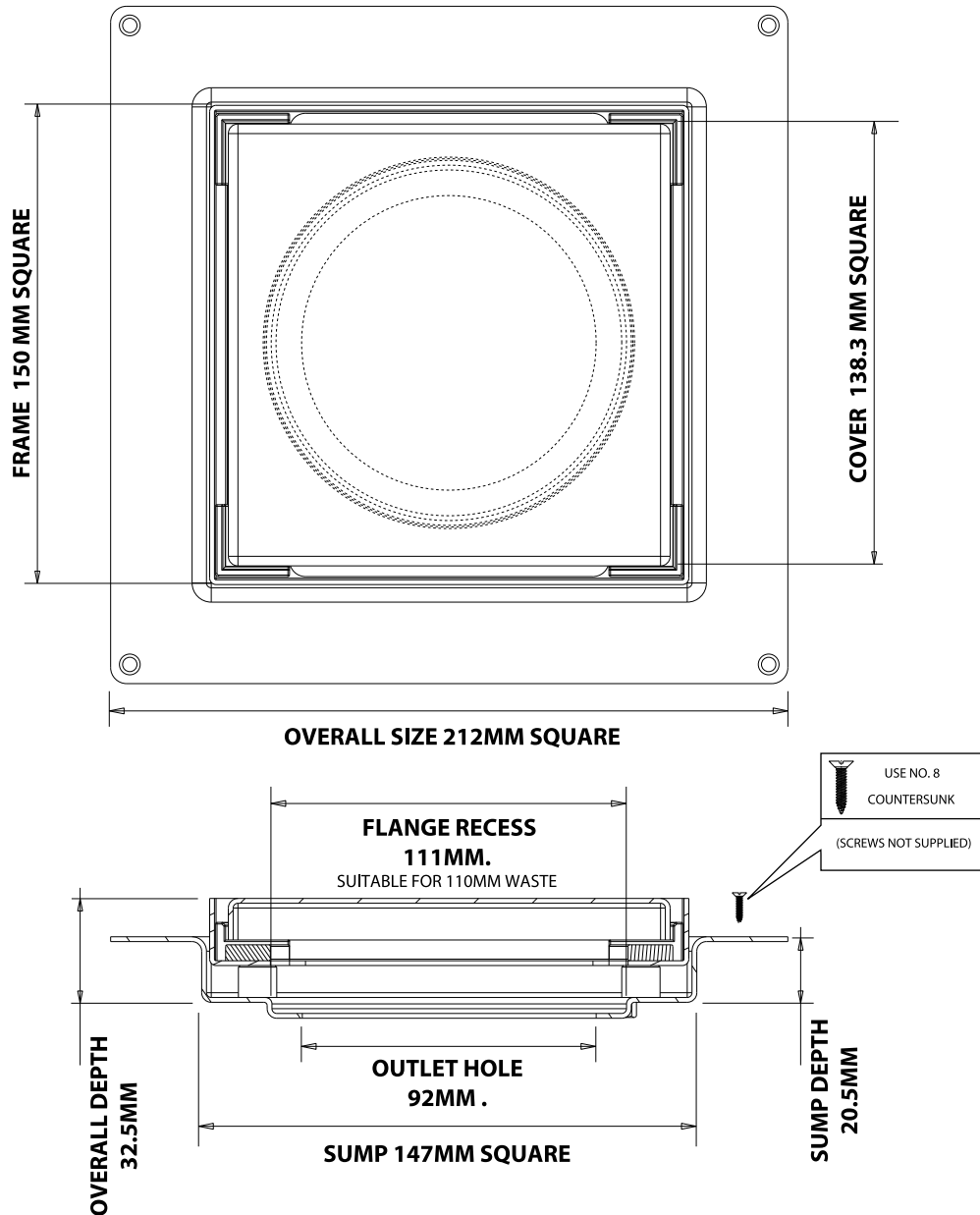

TILE DRAIN for TILE FLOORS



Component Parts

- 1 X Tile - Reversible.
- 1 X Frame.
- 1 X Tile Drain Body.
- 2 X Adjustable Legs.
- 2 X Centre Plastic Guides with four 10mm screws.
- 1 X Fittings bag containing:
- 4 X 15mm Screws.
- 4 X 4mm Plastic Spacers.
- 8 X 2mm Plastic Spacers.
- 1 X Suction Pad. (For Removing Tile)

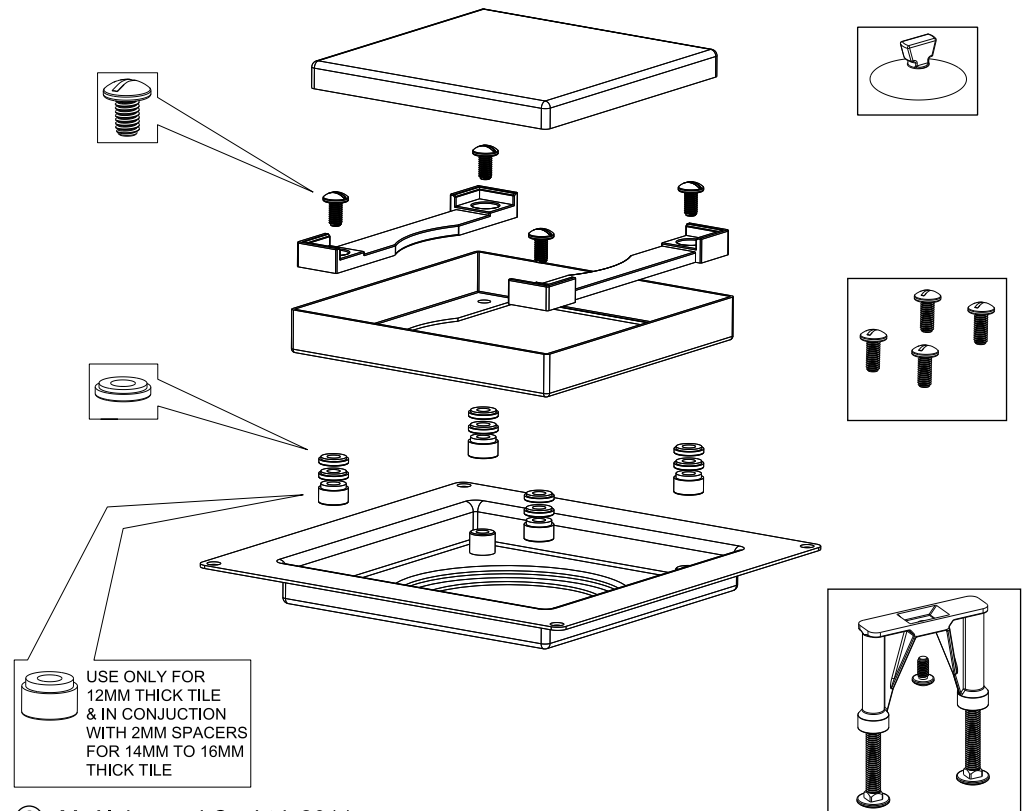

INSTALLATION GUIDELINES FOR TILE DRAIN

TILE DRAIN SHOULD BE USED WITH McALPINE 50mm WATER SEAL TRAPS ST90-70B, ST90-HP2B AND ST90-HPB

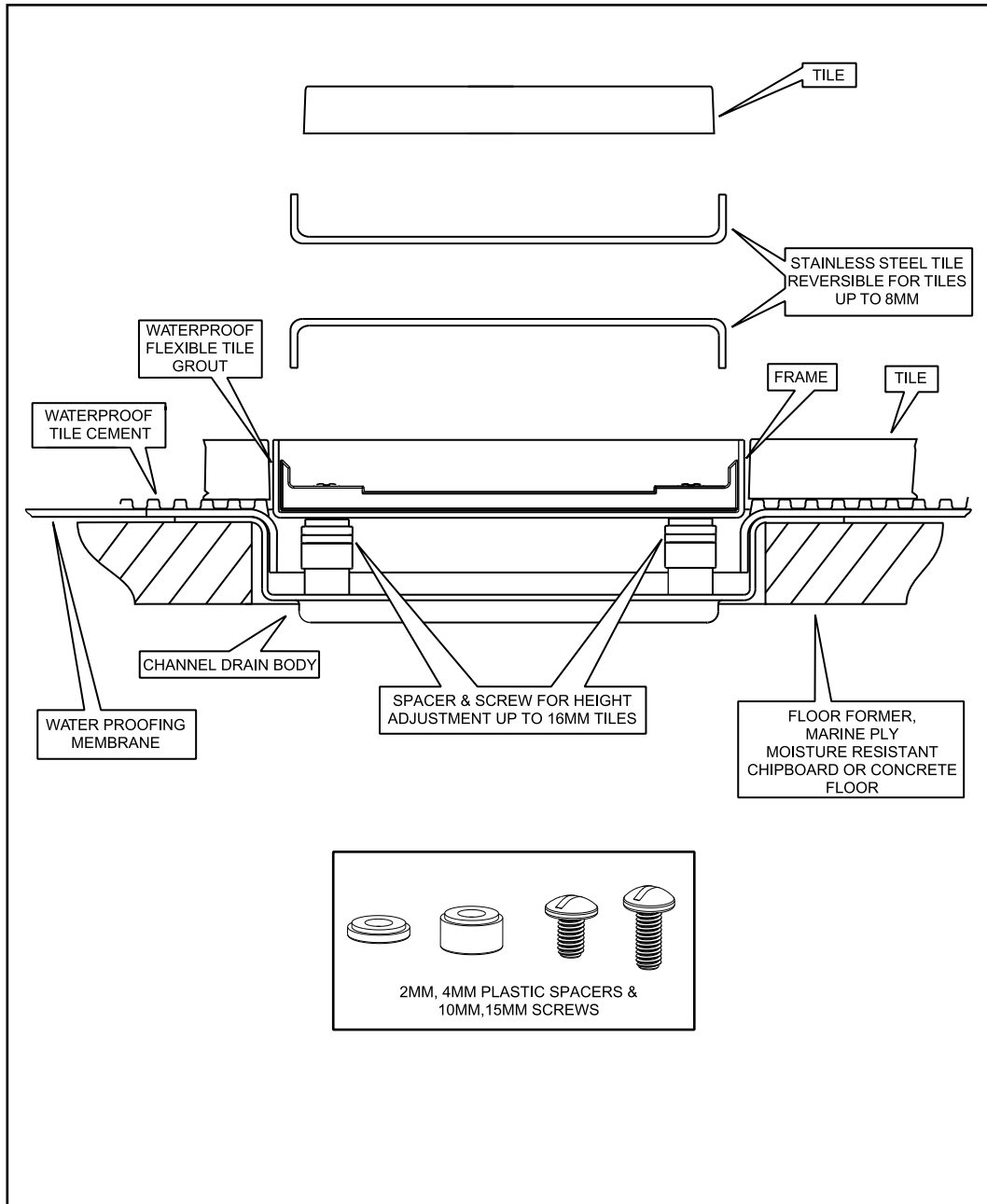

CHANNEL DRAINS CAN BE USED IN CONJUNCTION WITH

- Floor Former, moisture resistant chipboard or marine ply.
- Concrete floor installation, use adjustable height support legs (If required)
- A gradient to the Tile Drain of 1:40 should be provided and a waterproofing membrane or tanking system must be installed.
- Waterproof tile adhesive and flexible tile grout should always be used.
- The frame without Spacers suits tiles up to 8mm.
- Plastic Spacers and 15mm screws enable Frame adjustment to suit 10-16mm tiles.
- Stainless Steel Tile is reversible to accommodate tiles up to 8mm.

McALPINE TILE DRAINS SHOULD ONLY BE INSTALLED BY A COMPETENT PLUMBER AND OR SPECIALIST FLOORING CONTRACTOR